



**THE DISPLAY CHOICE
OF PROFESSIONALS™**

TX-2401 & TX-2401 White Touch Screen Monitor

www.agneovo.com

User Manual

TABLE OF CONTENTS

SAFETY INFORMATION

WEEE.....	4
-----------	---

PRECAUTIONS

Notice	5
Cautions When Setting Up	5
Cautions When Using.....	6
Cleaning and Maintenance.....	7
Notice for the LCD Monitor	8

CHAPTER 1: PRODUCT DESCRIPTION

1.1 Package Contents	9
1.2 Organizing the Cable.....	10
1.3 Installing the Stand.....	11
1.4 Adjusting the Tilt	11
1.5 Wall Mounting.....	12
1.6 LCD Monitor Overview	13
1.6.1 Front View	13
1.6.2 Rear View.....	13
1.6.3 Control Buttons.....	14

CHAPTER 2: MAKING CONNECTIONS

2.1 Connecting the AC Power	17
2.2 Connecting Input Source Signals	18
2.3 Connecting USB for Touch Screen Control	19
Touch Disable Function.....	19
2.4 Ventilation Requirements for Enclosure Locating.....	20

CHAPTER 3: USING THE LCD MONITOR

3.1 Turning on the Power	21
3.2 Displaying the OSD Menu	22
3.3 Adjusting Monitor Brightness.....	23
3.4 Adjusting Monitor Contrast	24

CHAPTER 4: ON SCREEN DISPLAY MENU

4.1 Using the OSD Menu	25
4.2 OSD Menu Tree	27

CHAPTER 5: ADJUSTING THE LCD MONITOR

5.1 Picture Menu	28
5.2 Advanced Menu.....	30
5.3 OSD Menu.....	31
5.4 Option Menu.....	32

CHAPTER 6: APPENDIX

6.1 Warning Messages.....	33
6.2 Timing.....	34
6.3 Touch Screen Driver Installation.....	35
6.3.1 Optional Calibration Tool Install.....	35

TABLE OF CONTENTS

6.4 Troubleshooting	37
6.5 Transporting the LCD Monitor	38

CHAPTER 7: SPECIFICATIONS

7.1 Monitor Specifications	39
7.2 Monitor Dimensions	40

SAFETY INFORMATION

Waste Electrical and Electronic Equipment-WEEE

Attention users in European Union private households



Disposal of Waste Equipment by Users in Private Household in the European Union.

This symbol on the product or on its packaging indicates that this product must not be disposed of with your other household waste. Instead, it is your responsibility to dispose of your waste equipment by handing it over to a designated collection point for the recycling of waste electrical and electronic equipment. The separate collection and recycling of your waste equipment at the time of disposal will help to conserve natural resources and ensure that it is recycled in a manner that protects human health and the environment. For more information about where you can drop off your waste equipment for recycling, please contact your local city office, your household waste disposal service or the shop where you purchased the product.

For Private Households in the European Union. To help conserve natural resources and ensure the product is recycled in a manner that protects human health and the environment, we would like to bring your attention to the following:

- The crossed-out dustbin on the device or outer packaging indicates the product is compliant with European WEEE (Waste Electrical and Electronic Equipment) Directive.
- Always dispose of the old devices separately from household waste.
- Batteries should be removed beforehand and disposed separately to the right collection system.
- You are responsible with regard to the deletion of personal data on old devices before disposal.
- Private households can hand in their old devices free of charge.
- For more information about where you can drop off your waste equipment for recycling, please contact your local city office, your household waste disposal service or the shop where you purchased the product.

PRECAUTIONS

PRECAUTIONS



Symbols used in this manual



This icon indicates the existence of a potential hazard that could result in personal injury or damage to the product.



This icon indicates important operating and servicing information.

Notice

- Read this User Manual carefully before using the LCD monitor and keep it for future reference.
- The product specifications and other information provided in this User Manual are for reference only. All information is subject to change without notice. Updated content can be downloaded from our web site at www.agneovo.com.
- To protect your rights as a consumer, do not remove any stickers from the LCD monitor. Doing so may affect the determination of the warranty period.

Cautions When Setting Up



Do not place the LCD monitor near heat sources, such as a heater, exhaust vent, or in direct sunlight.



Do not cover or block the ventilation holes in the housing.



Place the LCD monitor on a stable area. Do not place the LCD monitor where it may be subject to vibration or shock.



Place the LCD monitor in a well-ventilated area.



Do not place the LCD monitor outdoors.



Do not place the LCD monitor in a dusty or humid environment.



Do not spill liquid or insert sharp objects into the LCD monitor through the ventilation holes. Doing so may cause accidental fire, electric shock or damage the LCD monitor.

PRECAUTIONS

Cautions When Using



Use only the power cord supplied with the LCD monitor.



The power outlet should be installed near the LCD monitor and be easily accessible.



If an extension cord is used with the LCD monitor, ensure that the total current consumption plugged into the power outlet does not exceed the ampere rating.



Do not allow anything to rest on the power cord. Do not place the LCD monitor where the power cord may be stepped on.



If the LCD monitor will not be used for an indefinite period of time, unplug the power cord from the power outlet.



To disconnect the power cord, grasp and pull by the plug head. Do not tug on the cord; doing so may cause fire or electric shock.



Do not unplug or touch the power cord with wet hands.



WARNING:

Unplug the power cord from the power outlet and refer to qualified service personnel under the following conditions:



- When the power cord is damaged.
- If the LCD monitor has been dropped or the housing has been damaged.
- If the LCD monitor emits smoke or a distinct odor.



Ceiling mount or mount on any other horizontal surface overhead are not advisable.



WARNING:

Installation in contravention of the instructions may result in undesirable consequences, particularly hurting people and damaging property. Users who have already mounted the monitor on the ceiling or any other horizontal surface overhead are strongly advised to contact AG Neovo for consultations and solutions to help ensure a most pleasurable and fulfilling monitor experience.

PRECAUTIONS

Cleaning and Maintenance



Do not attempt to service the LCD monitor yourself, refer to qualified service personnel.
Opening or removing the covers may expose you to dangerous voltage or other risks.

Follow these instructions to clean and disinfect the screen without damaging its anti-glare coating or other product components.

It is recommended to use a soft and nonabrasive cloth or a microfiber cloth to clean the screen. Please **DO NOT** spray liquid directly onto the screen of the LCD monitor to prevent from getting moisture into any openings.

- **Step1: Turn off and unplug your monitor.** It's important to exercise safety precautions here to lower the risk of an electrical short circuit.
- **Step2: Spray the cleaning or disinfecting solution onto your microfiber cloth to avoid oversaturating it.** Be sure to avoid spraying the product directly onto the screen and keep the substance away from any flammable materials.

Note: *The tempered glass attached to the screen can be disinfected with alcohol (ethanol 95% by volume or isopropyl alcohol (IPA) in a concentration of 75%).*

- **Step3: Gently wipe the screen and its edges.** Rub the cloth on the screen in small circles to make sure that the alcohol is well-distributed. Make sure you avoid putting direct pressure on the glass.
- **Step4: Allow the monitor to dry before reconnecting any cables.**



Do not rub or tap the surface of the glass with sharp or abrasive items such as a pen or screwdriver. This may result in scratching the surface of the glass.



Do not attempt to service the LCD monitor yourself, refer to qualified service personnel.
Opening or removing the covers may expose you to dangerous voltage or other risks.

PRECAUTIONS

Notice for the LCD Monitor

In order to maintain the stable luminous performance, it is recommended to use low brightness setting.

Due to the lifespan of the lamp, it is normal that the brightness quality of the LCD monitor may decrease with time.

When static images are displayed for long periods of time, the image may cause an imprint on the LCD monitor. This is called image retention or burn-in.

To prevent image retention, do any of the following:

- Set the LCD monitor to turn off after a few minutes of being idle.
- Use a screen saver that has moving graphics or a blank white image.
- Switch desktop backgrounds regularly.
- Adjust the LCD monitor to low brightness settings.
- Turn off the LCD monitor when the system is not in use.

Things to do when the LCD monitor shows image retention:

- Turn off the LCD monitor for extended periods of time. It can be several hours or several days.
 - Use a screen saver and run it for extended periods of time.
 - Use a black and white image and run it for extended periods of time.
-

There are millions of micro transistors inside the LCD monitor. It is normal for a few transistors to be damaged and to produce spots. This is acceptable and is not considered a failure.

CHAPTER 1: PRODUCT DESCRIPTION

1.1 Package Contents

When unpacking, check if the following items are included in the package. If any of them is missing or damaged, contact your dealer.

LCD Monitor

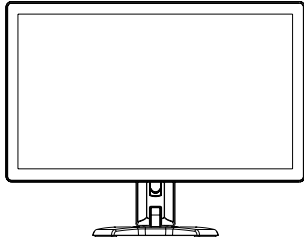

Quick Start Guide



USB Cable



HDMI Cable

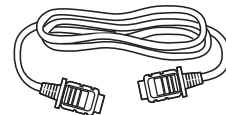

Power Adaptor(*)

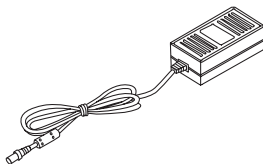

Power Cord

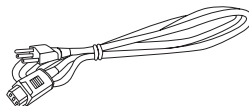

VGA Cable

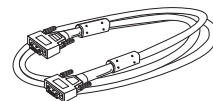

Note: (*)

- Use only the supplied power cord.
- The above pictures are for reference only. Actual items may vary upon shipment.
- (*) Must use only the supplied power adapter:
 - Vendor: Delta/Dachun/Adaptor
 - Model no.: ADP-36PH BX/DCT36W120300ZZ-C1/ATM065T-P120(Medical)
 - Rating: 12V, 3.0A /12V, 5.0A(Medical)

PRODUCT DESCRIPTION

1.2 Organizing the Cable

1. Lay the LCD monitor face down on a flat even surface.

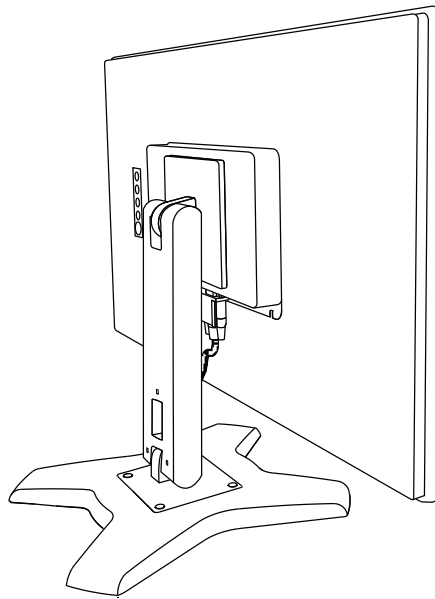

2. After connecting the cables to the monitor, use the cable management slot to organize all cables shown below.

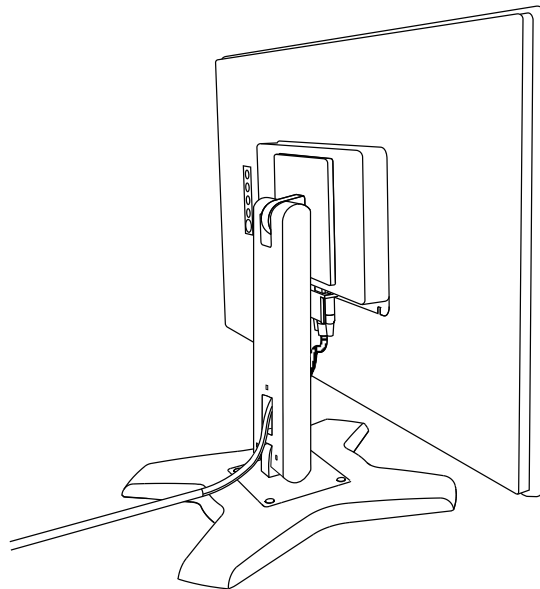

PRODUCT DESCRIPTION

1.3 Installing the Stand

1. Lay the LCD monitor face down on a flat even surface.
2. By aligning with the screw holes, install the stand to the rear of the LCD monitor.
3. Attach the stand to the monitor with the screws.

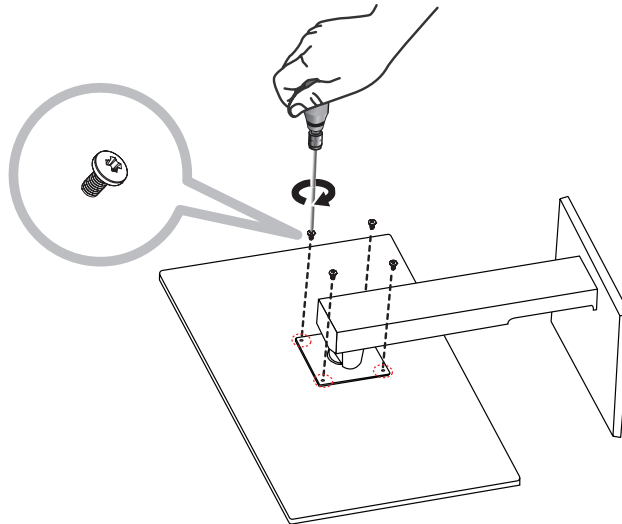

1.4 Adjusting the Tilt

For comfort viewing, tilt the LCD monitor up to an angle of -5° to 90° . Hold the stand with one hand and use the other to adjust the LCD monitor to the desired angle.

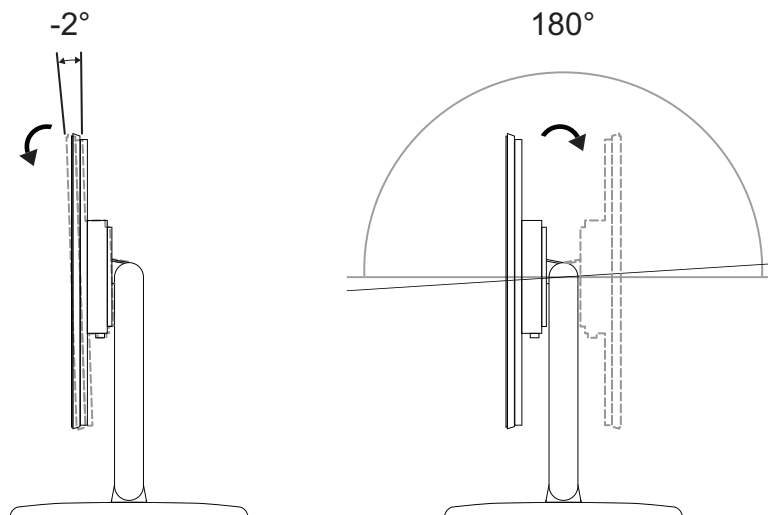

PRODUCT DESCRIPTION

1.5 Wall Mounting

To wall-mount the LCD monitor, screw the mounting bracket to the VESA holes at the rear of the LCD monitor.

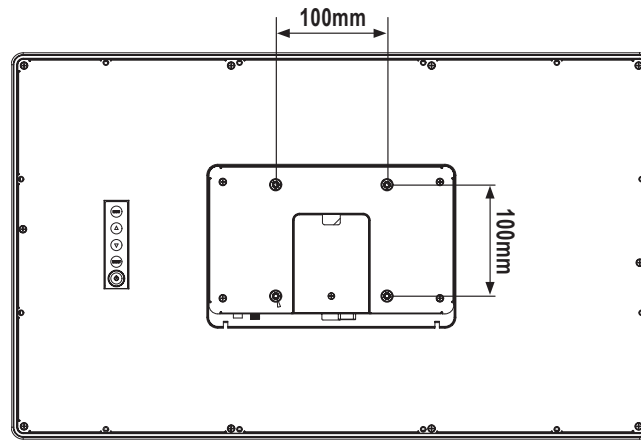

Note: Take measures to prevent the LCD monitor from falling down and lessen possible injury and damage to the monitor in case of earthquakes or other disasters.

- Use only the 100 x 100 mm wall mount kit recommended by AG Neovo. All AG Neovo wall mount kits comply with VESA standard.
- Secure the LCD monitor on a solid wall strong enough to bear its weight.
- It is suggested to wall mount the LCD monitor without tilting it facing downward.
- The distance between the back cover surface and the bottom of the screw hole is 7 mm. Please use four M4 screws diameter with proper length to mount your monitor. The mounting stand must be able to support at least 6.1 kg (13.5 lb).

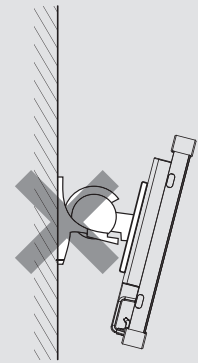

PRODUCT DESCRIPTION

1.6 LCD Monitor Overview

1.6.1 Front View

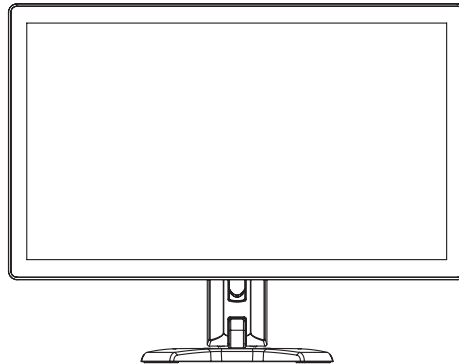

1.6.2 Rear View

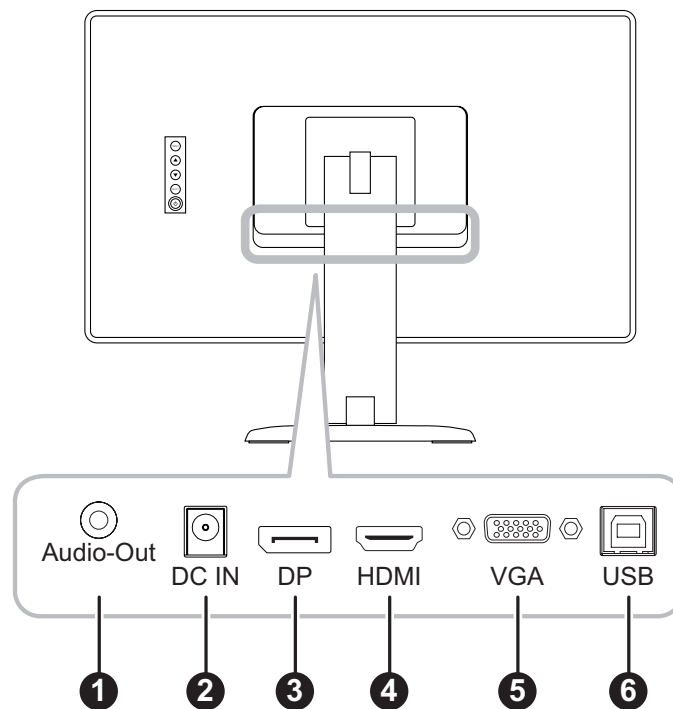

- 1 Audio OUT:**
Connect audio signals output.
- 2 DC IN:**
Connect with the supplied power adaptor.
- 3 DisplayPort:**
Connect DisplayPort signals input.
- 4 HDMI:**
Connect HDMI signals input.

PRODUCT DESCRIPTION

- 5 **VGA:**
Connect VGA signals input.
- 6 **USB:**
Connect USB for touch screen control.

1.6.3 Control Buttons

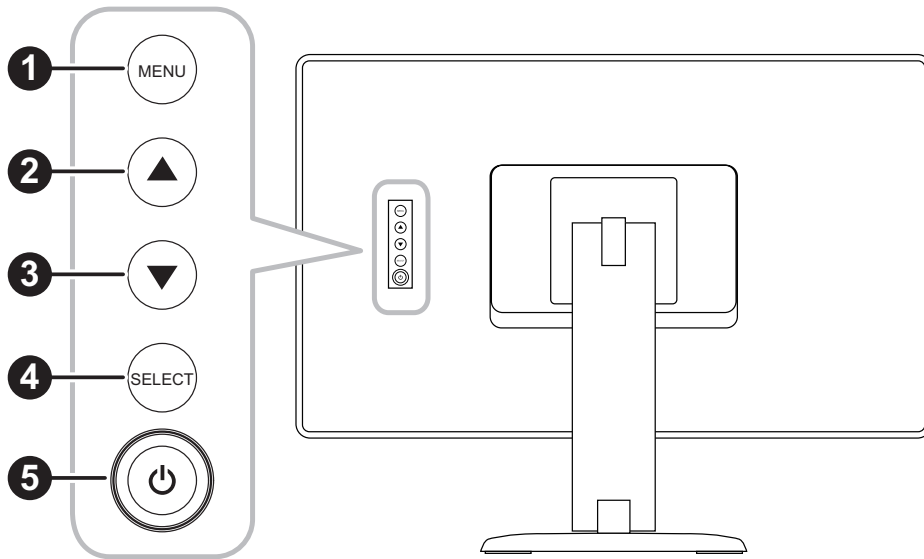

- 1 **MENU:**
 - OSD menu ON/OFF and return to main item.
- 2 **UP (▲): Hot Key: Brightness**
 - When OSD menu is ON, navigate through adjustment icons or adjust a function.
 - When the UP key is pressed, the brightness can be adjusted. The UP/DOWN key can be used for brightness adjustment.

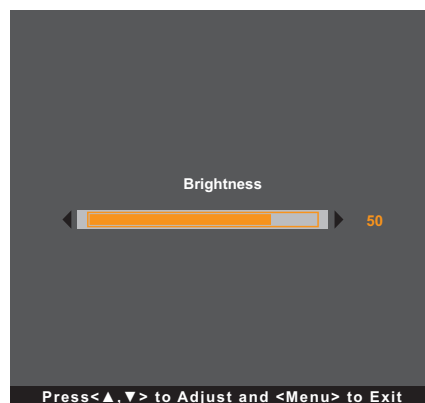

PRODUCT DESCRIPTION

3 DOWN (▼): Hot Key: Contrast

- When OSD menu is ON, navigate through adjustment icons or adjust a function.
- When the DOWN key is pressed, the contrast can be adjusted. The UP/DOWN key can be used for contrast adjustment.

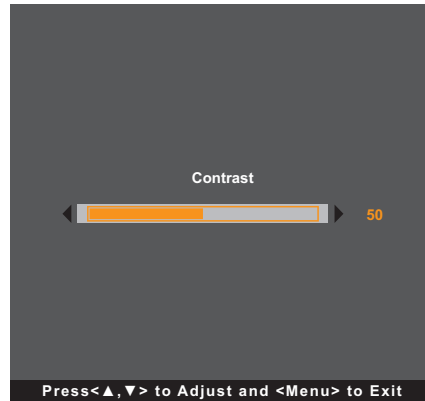

4 SELECT:

- When OSD menu is ON, the key is used for function adjustment confirmation.
- When selecting the input source:
 - If the monitor is in ON mode, press the SELECT key for 3 seconds to turn on the "Source Select" menu.
 - If the monitor is in Standby mode, press the SELECT key for 1 second to turn on the "Source Select" menu.

Note: For detailed adjustment of "Source Select", please refer to page 31.

5 POWER (⏻):

- Press to turn the monitor ON or OFF.

PRODUCT DESCRIPTION

Note: To lock/unlock the MENU key and/or the  key, press the MENU and ▼ keys simultaneously. Then select the desired lock/unlock function.

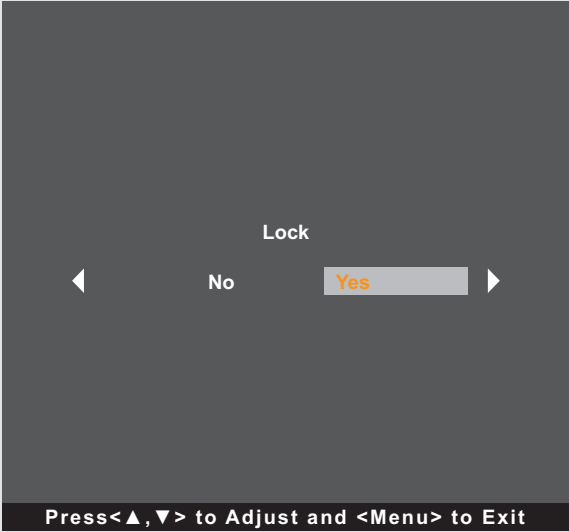
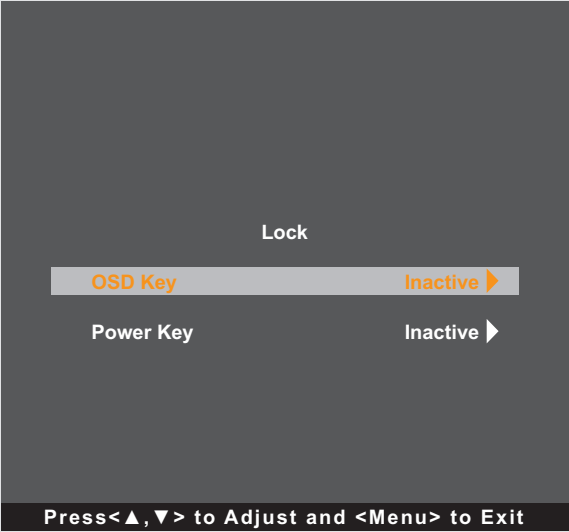

CHAPTER 2: MAKING CONNECTIONS



CAUTION:

Make sure that the LCD monitor is not connected to the power outlet before making any connections. Connecting cables while the power is ON may cause possible electric shock or personal injury.

2.1 Connecting the AC Power

1. Connect the power cord to the power adapter.
2. Connect the power adapter to the DC power input at the rear of the LCD monitor.
3. Connect the power cord plug to a power outlet or a power supply.

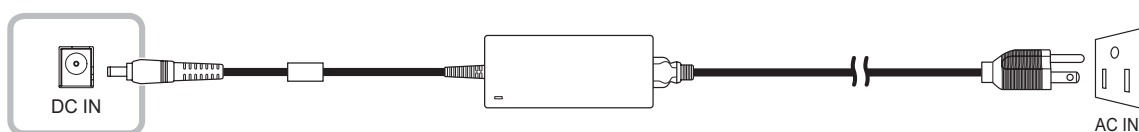

CAUTION:

When unplugging the power cord, hold the power cord by the plug head. Never pull by the cord.

MAKING CONNECTIONS

2.2 Connecting Input Source Signals

Input source signals can be connected with either of the following cables:

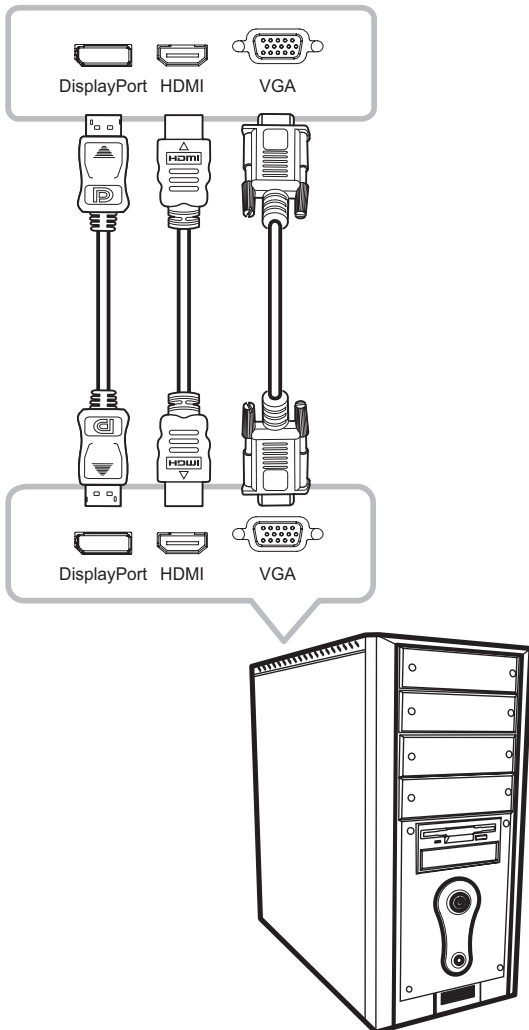

- **DisplayPort**

Connect one end of a DP cable to the DisplayPort connector of the LCD monitor and the other end to the DisplayPort connector of the computer.

- **HDMI**

Connect one end of an HDMI cable to the HDMI connector of the LCD monitor and the other end to the HDMI connector of the computer.

- **VGA**

Connect one end of a D-Sub (VGA) cable to the D-Sub (VGA) connector of the LCD monitor and the other end to the D-Sub (VGA) connector of the computer.

Note: To ensure the LCD monitor works well with your computer, please configure the display mode of your graphics card to make it less than or equal to 1920 x 1080 resolution and make sure the timing of the display mode is compatible with the LCD monitor. For compatible Video Modes of your LCD monitor, please refer to "6.2 Timing" on page 33.

MAKING CONNECTIONS

2.3 Connecting USB for Touch Screen Control

Connect one end of a USB cable to the USB connector of the LCD monitor and the other end to the USB connector of the computer.

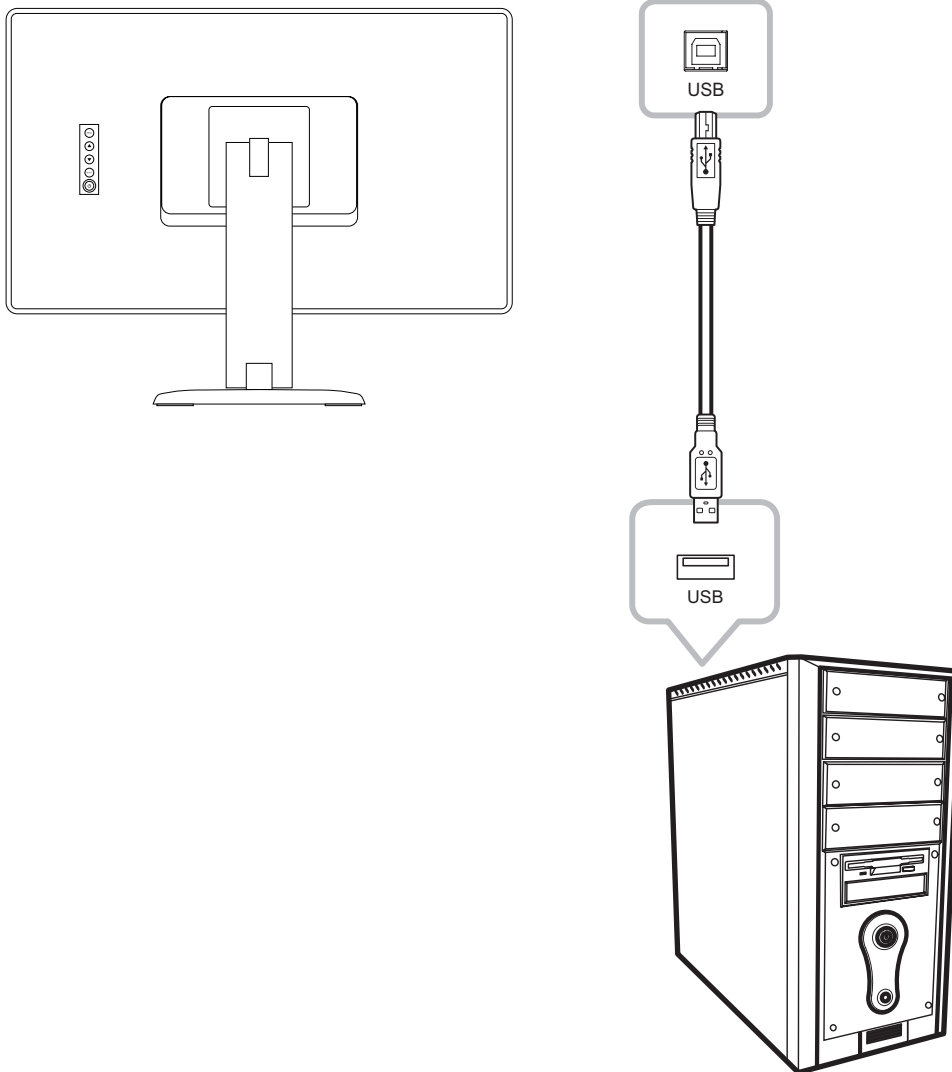

Touch Disable Function

To disable the touch function, do the following:

1. Press “Menu” and “Select” keys simultaneously. The “Touch disable” message appears on the screen.

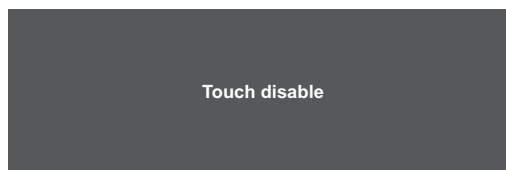

2. To enable the touch function, press “Menu” and “Select” keys simultaneously for five seconds.

MAKING CONNECTIONS

2.4 Ventilation Requirements for Enclosure Locating

To allow heat to disperse, avoid installing the LCD monitor directly on the cabinet wall and make sure the operating/storage temperature/humidity requirements are met as described below:

- Operating conditions: 0°C-40°C (32°F-104°F)
- Operating humidity (non-condensing): 20%-80%
- Operating altitude: < 10,000 feet (3,048m)
- Storage conditions: -20°C-60°C (-4°F-140°F)
- Storage humidity (non-condensing): 10%-90%

CHAPTER 3: USING THE LCD MONITOR

3.1 Turning on the Power

1. Connect the power to the LCD monitor. Refer to page 16.
2. Press the  key on the control panel to turn the LCD monitor on.

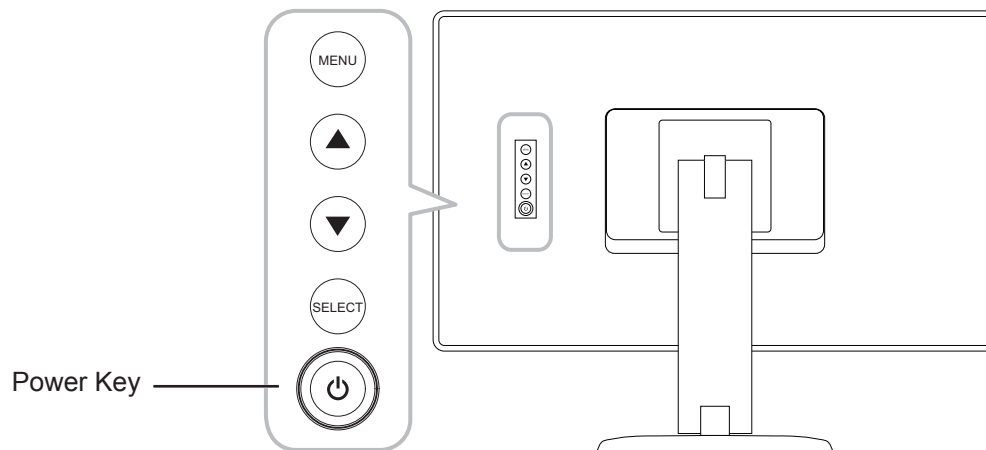

When the LCD monitor is turned on, press the  key on the control panel three times to turn off the LCD monitor.

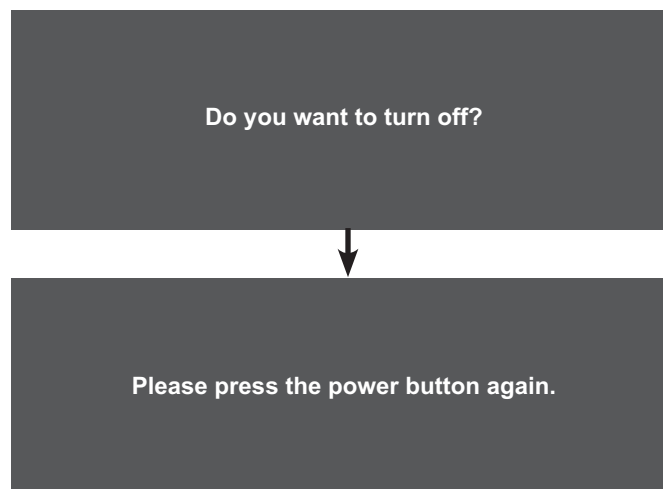

Note: The LCD monitor still consumes power as long as the power cord is connected to the power outlet. Disconnect the power cord to completely cut off power.

USING THE LCD MONITOR

3.2 Displaying the OSD Menu

Press the MENU key to open the OSD menu. Press the MENU key again to close the OSD menu.

For more information on adjusting settings, refer to page 24.

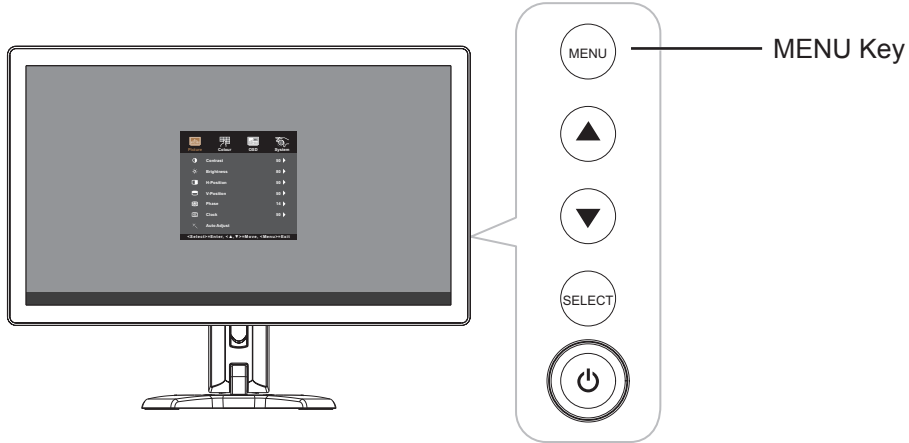

The following menu appears on the screen:

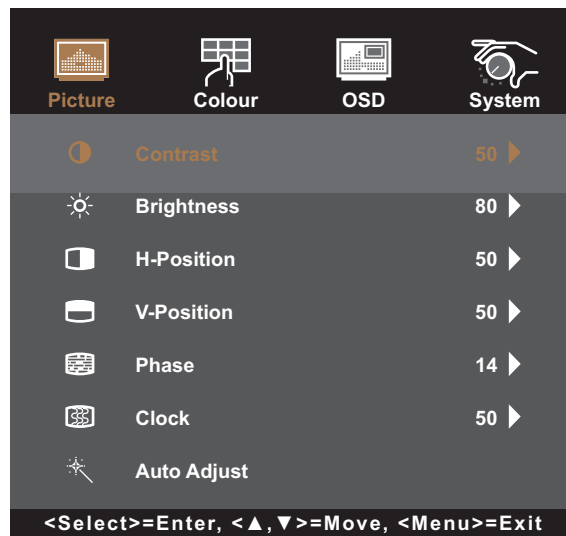

USING THE LCD MONITOR

3.3 Adjusting Monitor Brightness

Press the ▲ key to open the Brightness quick menu.

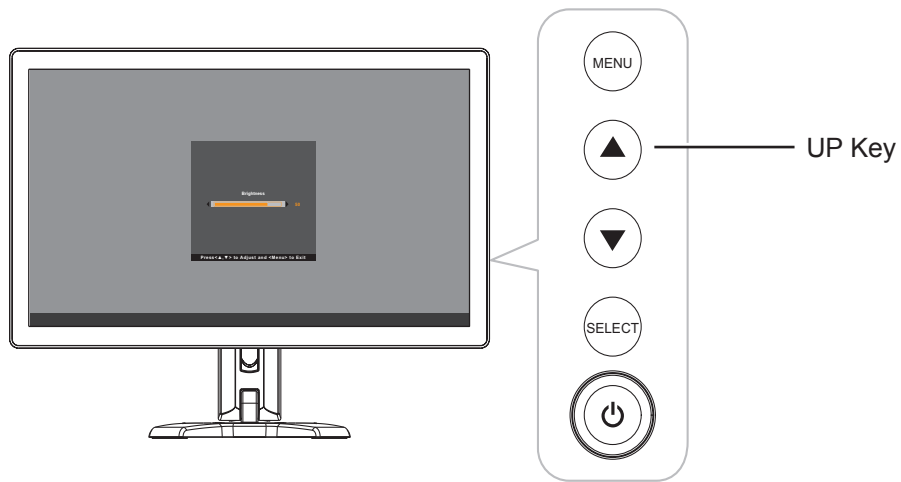

The following menu appears on the screen:

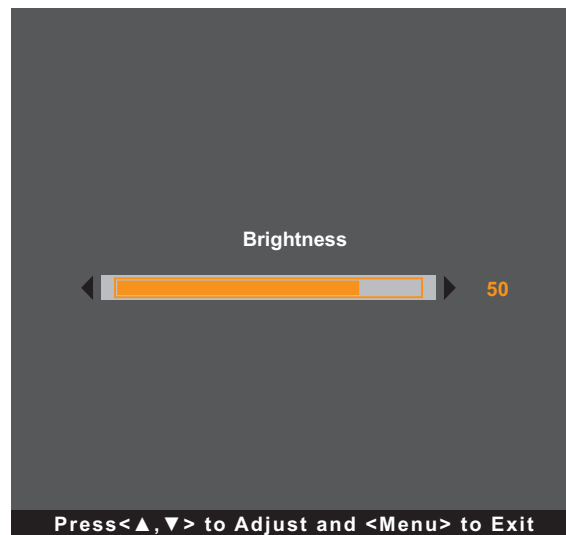

Then press the ▲/▼ keys to adjust the LCD monitor brightness level.

USING THE LCD MONITOR

3.4 Adjusting Monitor Contrast

Press the ▼ key to open the Contrast quick menu.

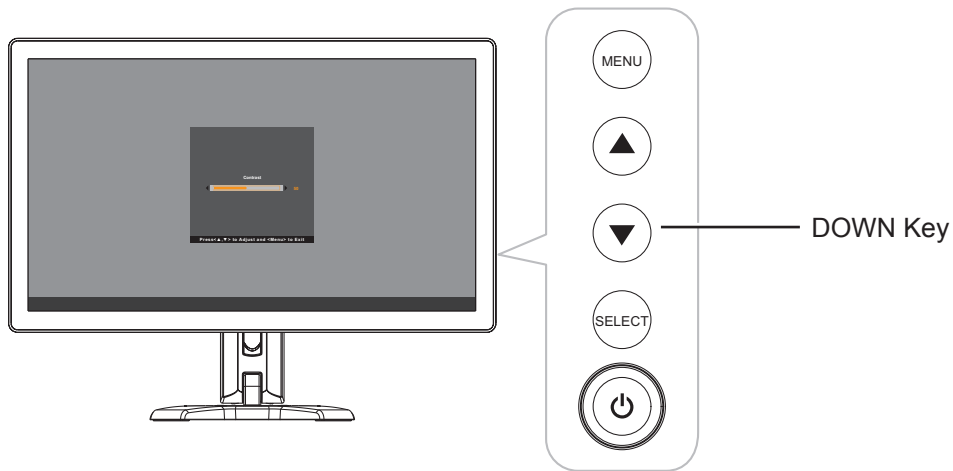

The following menu appears on the screen:

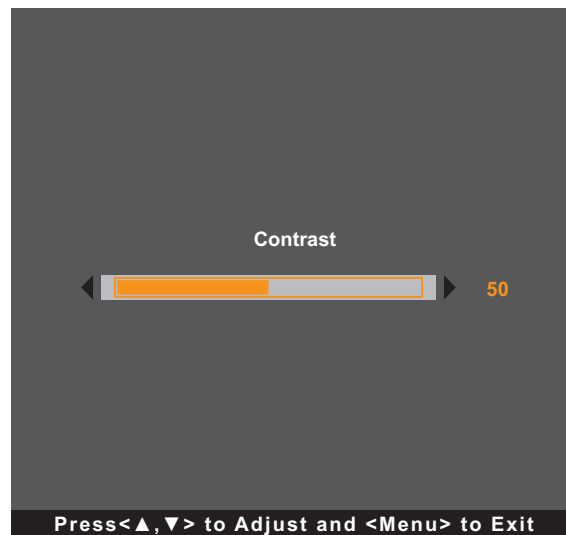

Then press the ▲/▼ keys to adjust the LCD monitor contrast level.

CHAPTER 4: ON SCREEN DISPLAY MENU

4.1 Using the OSD Menu

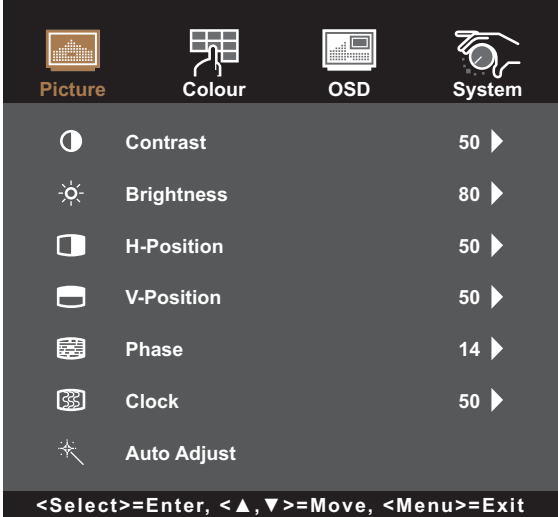
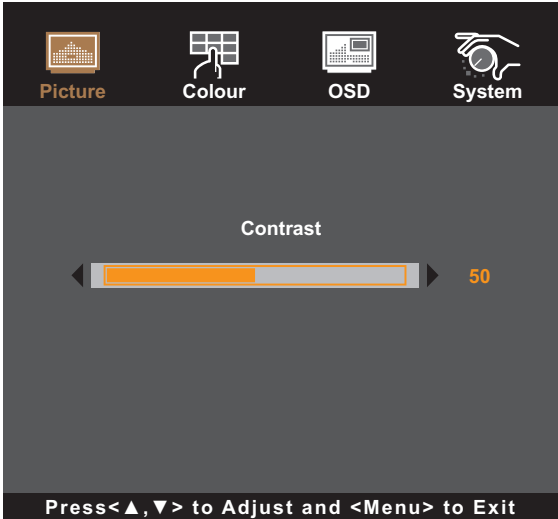
#	Menu Navigation	Operation
1	<p>Display the main menu screen.</p> 	<p>Press MENU.</p>
2	<p>Enter the submenu.</p>  <p>The active main menu and submenu icon is highlighted in orange.</p>	<ol style="list-style-type: none"> 1 Press ▲/▼ to select the main menu item. 2 Press SELECT to enter the submenu. 3 Press ▲/▼ to select the submenu item. 4 Press SELECT to enter the selected submenu.

ON SCREEN DISPLAY MENU

#	Menu Navigation	Operation
3	Adjust the settings or select the value. For example:  <p>The screenshot shows the OSD menu with four main categories: Picture, Colour, OSD, and System. The 'Auto Adjust' option is selected, and the 'No' option is highlighted. Navigation arrows are visible on the left and right sides. A footer instruction reads: 'Press <▲, ▼> to Adjust and <Menu> to Exit'.</p>	<ol style="list-style-type: none"> 1 Press ▲/▼ to adjust the value or select the setting. 2 Press SELECT to confirm the setting (if necessary).
4	Return to the previous menu and/or close the OSD window.	Press MENU once to return to the previous menu. Press MENU repeatedly (if necessary) to close the OSD window.

Note: When settings are modified, all changes are saved when the user does the following:

- Proceeds to another menu
- Exits the OSD menu
- Waits for the OSD menu to disappear

ON SCREEN DISPLAY MENU

4.2 OSD Menu Tree

Main Menu	Submenu	Reference
Picture	Contrast	Refer to page 28.
	Brightness	
	H-Position	
	V-Position	
	Phase	
	Clock	
	Auto Adjust	
Advanced	Color Temp	Refer to page 30.
	USER	
	Picture Mode	
	Sharpness	
OSD	OSD Timeout	Refer to page 31.
	OSD Position	
	OSD H-Position	
	OSD V-Position	
	Touch Switch	
Option	Reset	Refer to page 32.
	Language	
	Source Select	
	DisplayMode	
	Factory	



Note: Availability of some menu items depend on the input source signal. If the menu is not available, it is disabled and greyed out.

CHAPTER 5: ADJUSTING THE LCD MONITOR

5.1 Picture Menu

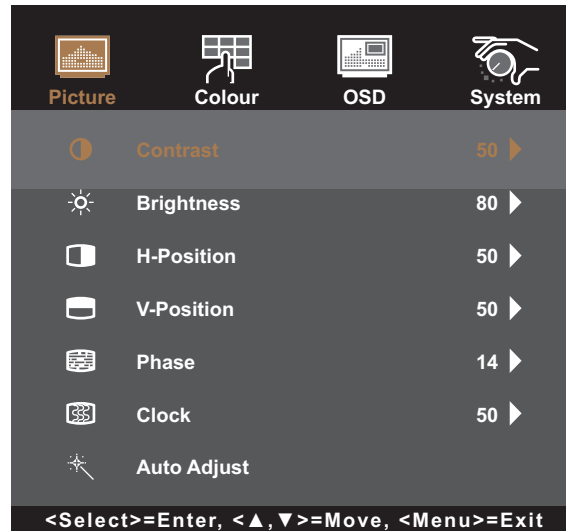
1. Press MENU on the control panel to call out the OSD window.
2. Press ▲/▼ to select Picture and then press SELECT to enter the menu.
3. Press ▲/▼ to select the submenu item and then press SELECT to enter its settings.

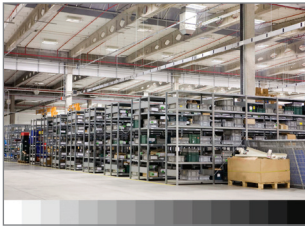
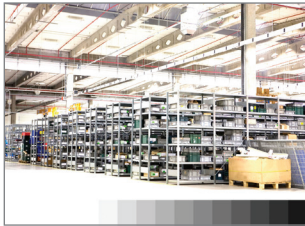
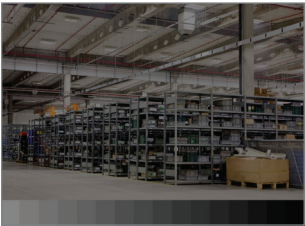
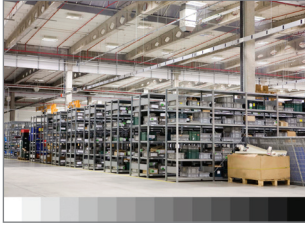

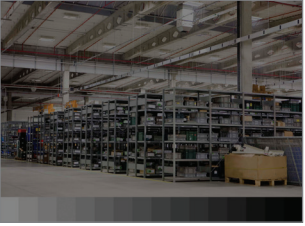
Item	Function	Operation	Range
Contrast	Adjusts the difference between the black level and the white level.	Press ▲/▼ to adjust the value.	0 to 100
	<div style="display: flex; justify-content: space-around;"> <div style="text-align: center;"> <p><i>Original Setting</i></p>  </div> <div style="text-align: center;"> <p><i>High Setting</i></p>  </div> <div style="text-align: center;"> <p><i>Low Setting</i></p>  </div> </div>		
Brightness	Adjusts the luminance of the screen image.	Press ▲/▼ to adjust the value.	0 to 100
	<div style="display: flex; justify-content: space-around;"> <div style="text-align: center;"> <p><i>Original Setting</i></p>  </div> <div style="text-align: center;"> <p><i>High Setting</i></p>  </div> <div style="text-align: center;"> <p><i>Low Setting</i></p>  </div> </div>		
H-Position (Horizontal Position)	Moves the screen image to the left or to the right.	Press ▲/▼ to adjust the value.	0 to 100
	<div style="border: 1px solid gray; padding: 5px; background-color: #f0f0f0;"> <p>Note: This menu item is only available if the source is VGA.</p> </div>		

ADJUSTING THE LCD MONITOR

Item	Function	Operation	Range
V-Position (Vertical Position)	Moves the screen image up or down. Note: <i>This menu item is only available if the source is VGA.</i>	Press ▲/▼ to adjust the value.	0 to 100
Phase	Adjusts the phase timing to synchronise with the video signal. Note: <i>This menu item is only available if the source is VGA.</i>	Press ▲/▼ to adjust the value.	0 to 100
Clock	Adjusts the frequency timing to synchronise with the video signal. Note: <i>This menu item is only available if the source is VGA.</i>	Press ▲/▼ to adjust the value.	0 to 100
Auto Adjust	Automatically optimises image display.  Note: <i>This menu item is only available if the source is VGA.</i>	Press ▲/▼ to select the setting and then press SELECT to confirm.	No Yes

ADJUSTING THE LCD MONITOR

5.2 Advanced Menu

1. Press MENU on the control panel to call out the OSD window.
2. Press ▲/▼ to select Colour and then press SELECT to enter the menu.
3. Press ▲/▼ to select the submenu item and then press SELECT to enter its settings.

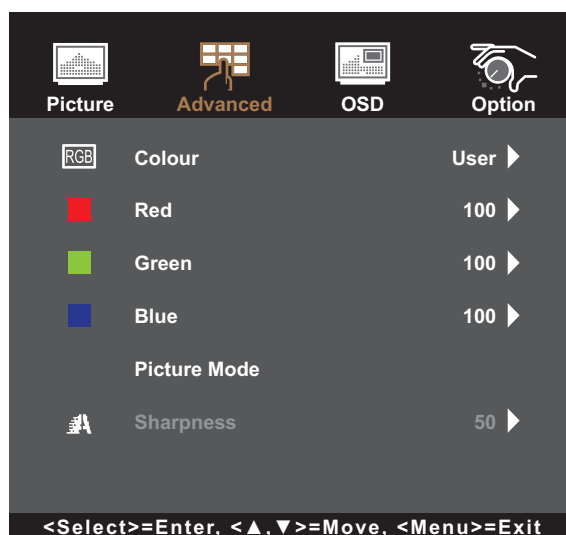

Item	Function	Operation	Range
Colour	Provides several colour adjustment settings.	Press ▲/▼ to select the setting and then press SELECT to confirm.	5500K 6500K 7500K 9300K User
	Colour temperature can be set to: <ul style="list-style-type: none"> • 5500K: Applies a reddish tint for warmer colours. • 6500K: This is the default colour temperature commonly used for normal lighting conditions. • 7500K: Applies the screen colour between red and blue. • 9300K: Applies a bluish tint for cooler colours. • User: This allows users to set the colour temperature by adjusting the Red, Green, and Blue value according to one's preference. 		
Picture Mode	Choose a predefined picture setting.	Press the▲/▼button on the control panel to select the setting.	Vivid Standard
Sharpness	Adjusts the clarity and focus of the screen image.	Press ▲/▼ to adjust the value.	0 to 100
	Note: The Sharpness function is not supported with the following resolutions: <ul style="list-style-type: none"> • 1920x1080 		

ADJUSTING THE LCD MONITOR

5.3 OSD Menu

1. Press **MENU** on the control panel to call out the OSD window.
2. Press **▲/▼** to select **OSD** and then press **SELECT** to enter the menu.
3. Press **▲/▼** to select the submenu item and then press **SELECT** to enter its settings.



Item	Function	Operation	Range
OSD Timeout	Sets the length of time (in seconds) the OSD screen is displayed. When the time elapses, the OSD screen is automatically inactivated.	Press ▲/▼ to adjust the value.	5 to 60
OSD Position	Sets the OSD window location on the screen.	Press ▲/▼ to select the setting and then press SELECT to confirm.	User-defined
OSD H-Position (Horizontal Position)	Moves the OSD window to the left or right of the screen.	Press ▲/▼ to adjust the value.	0 to 100
OSD V-Position (Vertical Position)	Moves the OSD window up or down the screen.	Press ▲/▼ to adjust the value.	0 to 100
Touch Switch	<p>Sets the touch setting.</p> <ul style="list-style-type: none"> • Normal: Supports 10-point multi-touch. Touch the screen with bare fingers or stylus. • Glove: Supports 5-point multi-touch. Touch the screen with gloves on. • Through-Glass: Touch the screen through the glass. Supports 2-point multi-touch and maximum cover glass thickness ≤ 6 mm. <p>Note: After setting the Touch Switch setting, exit the OSD menu and restart the LCD display.</p>	Press ▲/▼ to select the setting and then press SELECT to confirm.	Normal Glove Through-Glass

ADJUSTING THE LCD MONITOR

5.4 Option Menu

1. Press MENU on the control panel to call out the OSD window.
2. Press ▲/▼ to select System and then press SELECT to enter the menu.
3. Press ▲/▼ to select the submenu item and then press SELECT to enter its settings.

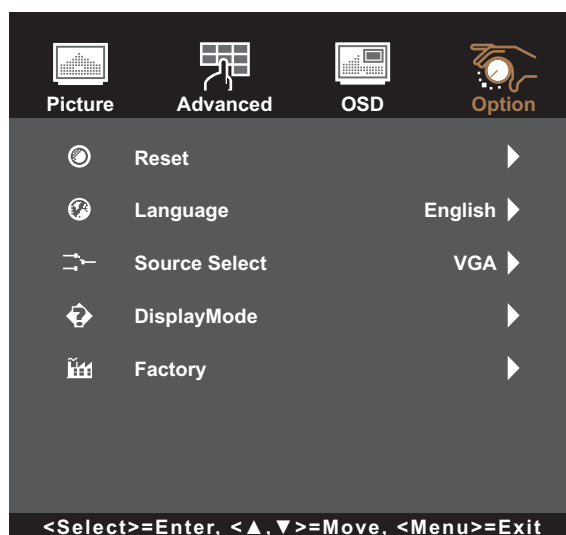



Item	Function	Operation	Range
Reset	Resets the device to the factory default settings.	Press ▲/▼ to select the setting and then press SELECT to confirm.	No Yes
Language	Selects the language used for OSD menus.	Press ▲/▼ to select the setting and then press SELECT to confirm.	English Français Deutsch Italiano Español 日本語 繁中 簡中
Source Select	Sets the input source. Note: <i>If the source is set to "Auto" then the monitor detects the input source automatically.</i>	Press ▲/▼ to select the setting and then press SELECT to confirm.	Auto VGA HDMI DP
DisplayMode	View the source, resolution, and frequency.	Press MENU to return to the System menu.	N/A
Factory	This is maintenance function for service main. Do not operate this function.	N/A	N/A

CHAPTER 6: APPENDIX

6.1 Warning Messages

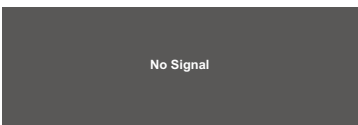
When any of these warning messages appear, check the following items.

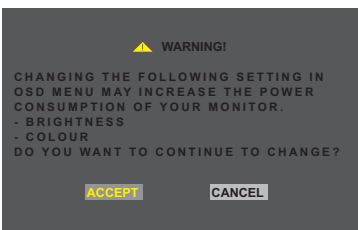
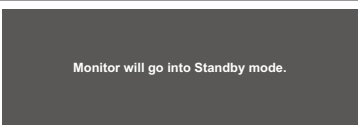
Warning Message	Cause	Solution
 <p>No Signal</p>	<p>The LCD monitor cannot detect the input source signal.</p>	<ul style="list-style-type: none"> √ Check if the input source is turned ON. √ Check if the signal cable is properly connected. √ Check if any pin inside the cable connector is twisted or broken.
 <p>Out of Range</p>	<p>The resolution or the refresh rate of the graphics card of the computer is set too high.</p> <div style="border: 1px solid gray; padding: 5px; margin-top: 10px;"> <p>Note: <i>If you see the “Out of Range” message on the screen, then the OSD menu cannot be operated.</i></p> </div>	<ul style="list-style-type: none"> √ Change the resolution or the refresh rate of the graphics card.
 <p>▲ WARNING! CHANGING THE FOLLOWING SETTING IN OSD MENU MAY INCREASE THE POWER CONSUMPTION OF YOUR MONITOR. - BRIGHTNESS - COLOUR DO YOU WANT TO CONTINUE TO CHANGE? ACCEPT CANCEL</p>	<p>Increasing the brightness and/or contrast may increase the power consumption of the monitor.</p>	<ul style="list-style-type: none"> √ Select “ACCEPT” to confirm or “CANCEL” to cancel the modifications.
 <p>Monitor will go into Standby mode.</p>	<p>The LCD monitor is in Standby mode. The LCD monitor will enter Standby mode when experiencing a sudden signal disconnecting problem.</p>	<ul style="list-style-type: none"> √ Check if the signal cable is properly connected. √ The monitor can be activated by pressing any keyboard, triggering the mouse, or touching the screen. √ Check if the correct source is selected in the OSD > System > Source select menu. Refer to page 31.

APPENDIX

6.2 Timing

Mode	Resolution	H-Frequency(khz)	V-Frequency(hz)
1	720 x 400	31.47	70Hz
2	640 x 480	31.47	60Hz
3	640 x 480	35	66Hz
4	640 x 480	37.86	72Hz
5	640 x 480	37.5	75Hz
6	800 x 600	35.16	56Hz
7	800 x 600	37.88	60Hz
8	800 x 600	46.88	75Hz
9	800 x 600	48.08	72Hz
10	832 x 624	49.72	75Hz
11	1024 x 768	48.36	60Hz
12	1024 x 768	56.48	70Hz
13	1024 x 768	60.02	75Hz
14	1280 x 1024	64	60Hz
15	1280 x 1024	80	75Hz
16	1152 x 864	67.5	75Hz
17	1280 x 960	60	60Hz
18	1440 x 900	56	60Hz
19	1440 x 900	70.6	75Hz
20	1680 x 1050	65.2	60Hz
21	1680 x 1050	82.3	75Hz
22	1280 x 768	47.77	60Hz
23	1920 x 1080	67.5	60Hz

APPENDIX

6.3 Touch Screen Driver Installation

The LCD monitor is available with USB connections. The touch driver can be downloaded from <https://www.agneovo.com/global/support/download-center>

The supported operating systems are Windows/Linux/Android/Mac OS (Windows 7/8/10/11 Multi touch without driver).

Please Note:

- Your LCD monitor is Microsoft® Windows® HID (Human Interface Device) compatible if you use the USB touch screen interface. No additional software driver is required for general operation of the touch screen.

Note: A calibration tool can be installed for improved touch position accuracy. Please refer to “6.3.1 Optional Calibration Tool Install”.

6.3.1 Optional Calibration Tool Install

To calibrate the touch screen in Windows 7/8/10/11 environment:

1. Tap Start > Control Panel > Hardware and Sound.

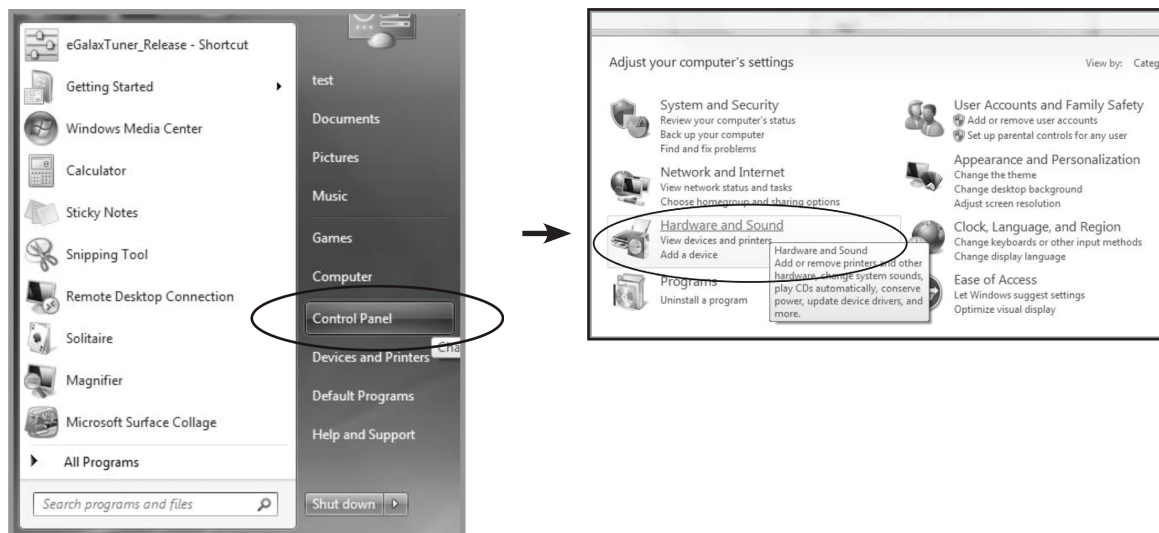

APPENDIX

2. In Tablet PC Settings, tap “Calibrate the screen for pen or touch input”.
3. On the Display tab, in Display options, tap “Calibrate” and then “Yes” to allow the program to make changes.

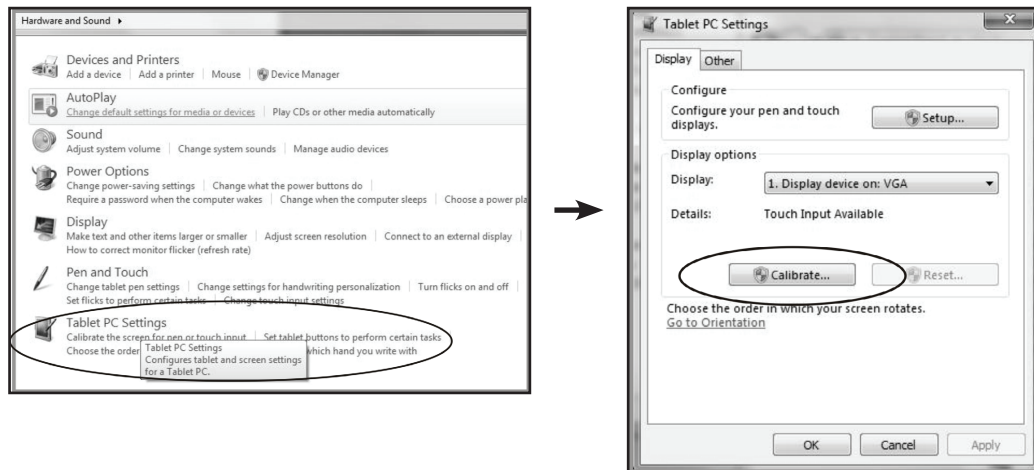

4. Follow the on-screen instructions to calibrate the touch screen.

APPENDIX

6.4 Troubleshooting

Problems	Possible Cause and Solution
No picture.	<ul style="list-style-type: none"> • Check if the LCD monitor is turned ON. • Check if the power adapter is properly connected to the LCD monitor. • Check if the power cord is plugged into the power outlet and to the power adapter. • Check if the LCD monitor is properly connected to the input source. • Check if the input source is turned ON. • Check if the input source is in standby mode, move the mouse or press any key to wake it up. <div style="border: 1px solid gray; padding: 5px; margin-top: 10px;"> <p>Note: Do not connect the USB cable to the LCD monitor in order to charge your laptop. Doing so will disable the LCD monitor to wake up from standby mode by simply touching the screen.</p> </div>
Partial image or incorrectly displayed image.	<ul style="list-style-type: none"> • Check to see if the resolution of your computer is higher than that of the LCD monitor. • Reconfigure the resolution of your computer to make it less than or equal to 1920 x 1080.
Image position is incorrect.	<ul style="list-style-type: none"> • For VGA input, adjust the “H-Position (Horizontal Position)” and “V-Position (Vertical Position)” settings in Picture menu. Refer to page 27.
The displayed texts are blurry.	<ul style="list-style-type: none"> • For VGA input, run the Auto Adjust function in Picture menu. Refer to page 28.
Red, blue, green, white dots appear on the screen.	<ul style="list-style-type: none"> • There are millions of micro transistors inside the LCD monitor. It is normal for a few transistors to be damaged and to produce spots. This is acceptable and is not considered a failure.
Faint shadows from a static image appear on the screen.	<ul style="list-style-type: none"> • Turn off the LCD monitor for extended periods of time. • Use a screen saver or a black and white image and run it for extended periods of time.
Dew formed on the LCD monitor.	<ul style="list-style-type: none"> • This normally happens when the LCD monitor is moved from a cold room to a hot room temperature. Do not turn ON the LCD monitor, wait for the dew condensation to disappear.

APPENDIX

6.5 Transporting the LCD Monitor

To transport the LCD monitor for repair or shipment, place the monitor in its original packaging box.

1. Place the two foam cushions on each side of the LCD monitor for protection.
2. Place the LCD monitor down in the box.
3. Place the accessory box on the designated area (if necessary).
4. Close and tape the box.

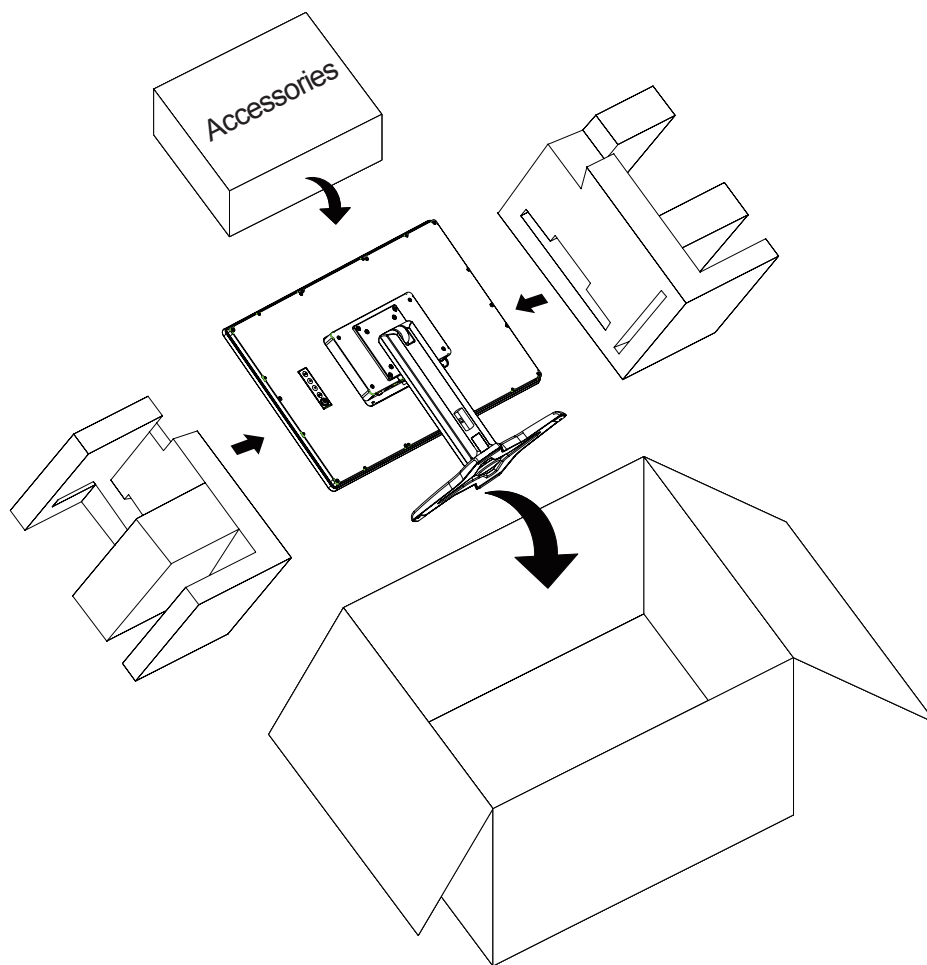

CHAPTER 7: SPECIFICATIONS

7.1 Monitor Specifications

		TX-2401/ TX-2401 White
Panel	Panel Type	LED-Backlit TFT LCD(VA Technology)
	Panel Size	23.8"
	Max. Resolution	FHD 1920 x 1080
	Pixel Pitch	0.274 mm
	Brightness	250 cd/m ²
	Contrast Ratio	3000:1
	Viewing Angle (H/V)	178°/178°
	Display Colour	16.7M
	Response Time	5 ms
Frequency (H/V)	H Freq.	30 kHz-84 kHz
	V Freq.	56 Hz-76 Hz
Input	DisplayPort	1.2a x 1
	HDMI	1.3 x 1
	VGA	15-Pin D-Sub x 1
External Control	RJ11	Yes
Touch Screen	Technology	Projective Capacitive
	Positional Accuracy	± 2.5 mm
	Panel Interface	USB (Type-B) / Service Port
	Multi-touch Plug & Play	40-point touch for Windows® 7/8/10/11 Linux/Android 2.6.36 or later Mac OS 10.11-10.14
	Single Touch Support by Driver	1 point touch for Windows XP/Embedded/7/8/10/11 Linux/Android 2.6.35 and older
Power	Power Supply	External
	Power Requirements	DC 12V, 2.5A
	On Mode	17W (On)
	Standby Mode	<0.4W
	Off Mode	<0.2W
Glass	Surface Treatment	Clear Glass
	Thickness	3.3 mm (0.13")
	MOHS Hardness	5
	IK Rating	IK07
Durability and Protection	IP Rating	Front-Sided IP65
Operating Conditions	Temperature	0°C-40°C (32°F-104°F)
	Humidity	20%-80% (non-condensing)
Storage Conditions	Temperature	-20°C-60°C (-4°F-140°F)
	Humidity	10%-90% (non-condensing)
Mounting	VESA FPMPI	Yes (100 x 100 mm)
Stand	Tilt	-5° to 180°
Security	Kensington Security Slot	Yes
Dimensions	Product with Base (W x H x D)	575.1 x 451.3 x 279.7 mm (22.6" x 17.8" x 11.0")
	Packaging (W x H x D)	370.0 x 530.0 x 660.0 mm (14.6" x 20.9" x 26.0")
Weight	Product with Base	7.8 kg (17.2 lb)
	Packaging	11.4 kg (25.1 lb)

Note: All specifications are subject to change without prior notice.

SPECIFICATIONS

7.2 Monitor Dimensions

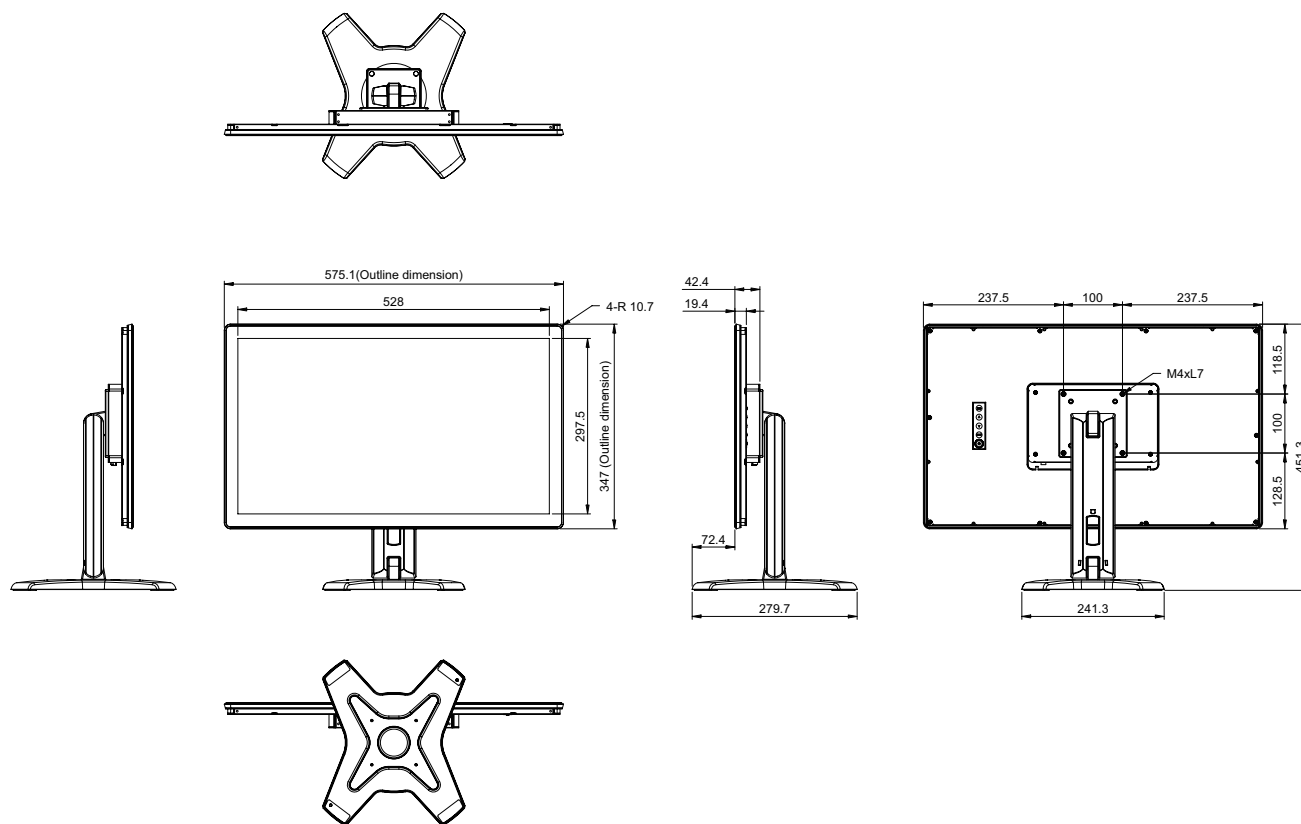

AG Neovo

Company Address: 5F-1, No. 3-1, Park Street, Nangang District, Taipei, 11503, Taiwan.

Copyright © 2026 AG Neovo. All rights reserved.

TX-2401 Eprel registration number: 1121207

TX241A_UM_V014